

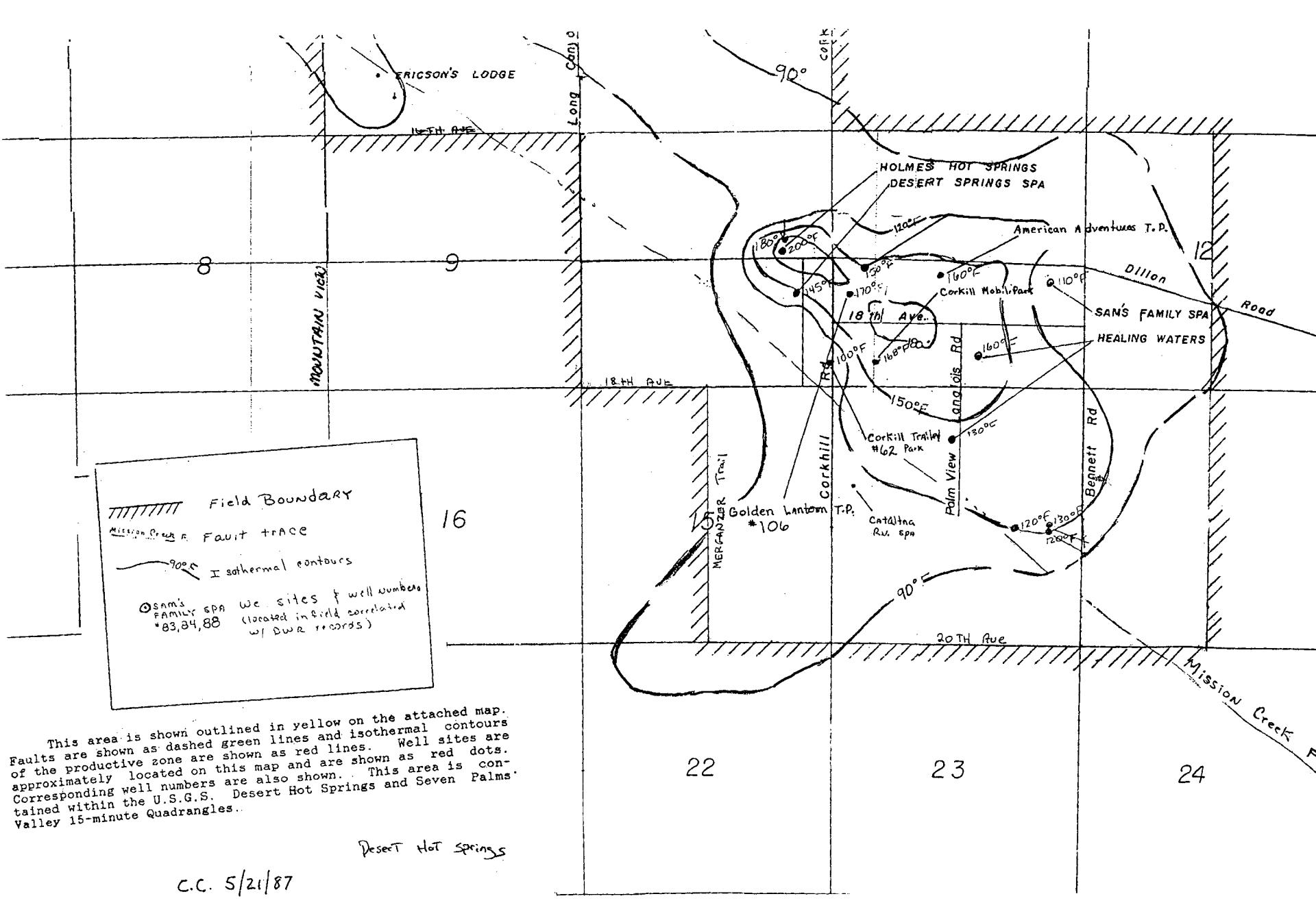

The resource temperature is higher in the Dillon Road area than those in Desert Hot Springs.

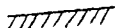
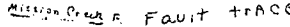

 Field Boundary
 Mission Creek Fault trace
 Isothermal contours
 16
 San's Family Spa well sites #83, 84, 88 (located in field correlated w/ DWR records)

This area is shown outlined in yellow on the attached map. Faults are shown as dashed green lines and isothermal contours of the productive zone are shown as red lines. Well sites are approximately located on this map and are shown as red dots. Corresponding well numbers are also shown. This area is contained within the U.S.G.S. Desert Hot Springs and Seven Palms Valley 15-minute Quadrangles.

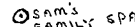
Desert Hot Springs

C.C. 5/21/87

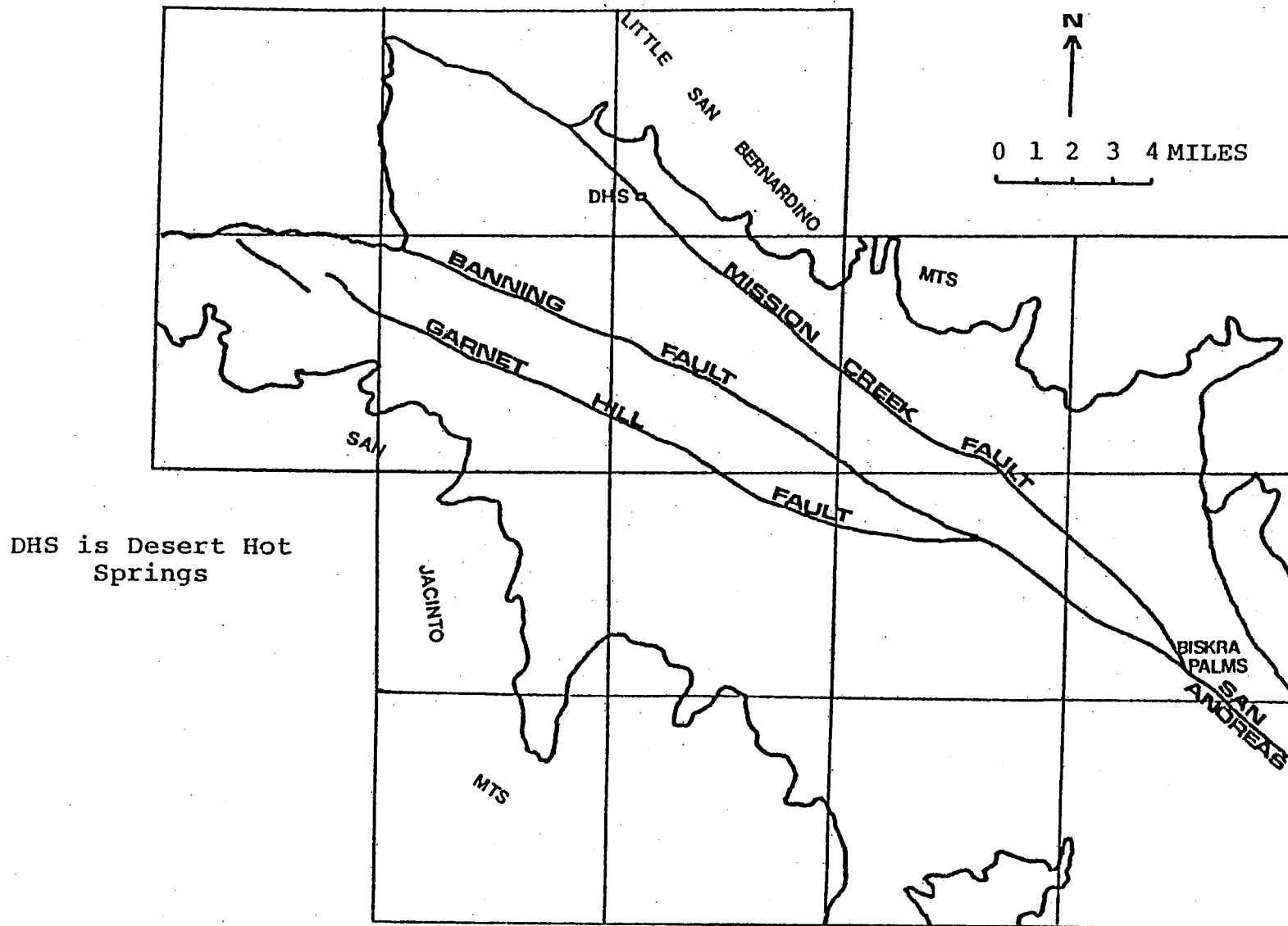

Figure 2-2 Structure of the upper Coachella Valley (DWR, 1964).